

bastidores | *châssis* | frames

perfiles bastidor | profilés de cadre | frame profiles

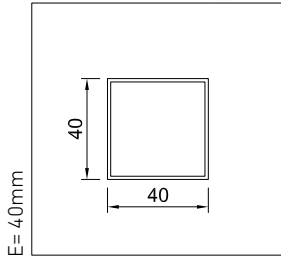

40N



60N

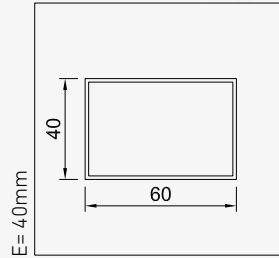

40SC

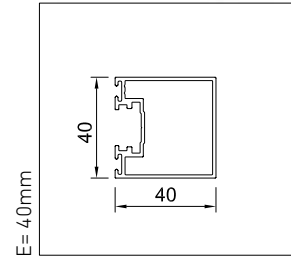

40N.C

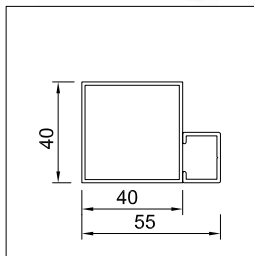

60N.C

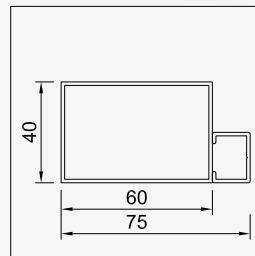

40SC.C

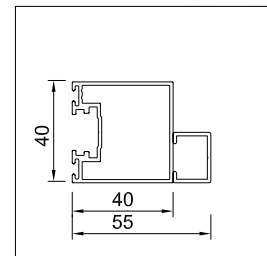

40H

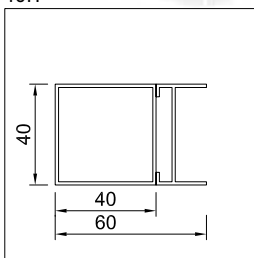

60H

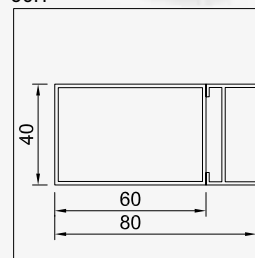

40SC.H

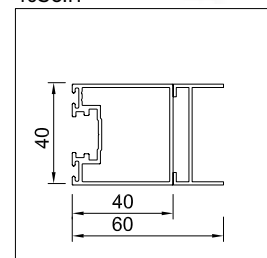

perfiles bastidor | profilés de cadre | frame profiles



60SC

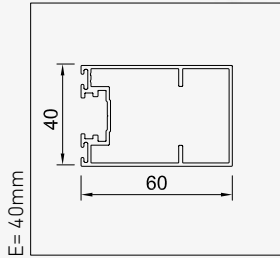

E = 40mm



60.50L

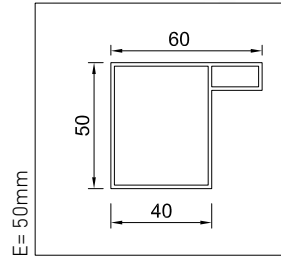

E = 50mm



L60

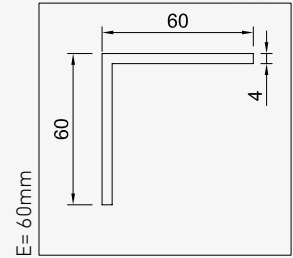

E = 60mm



60SC.C

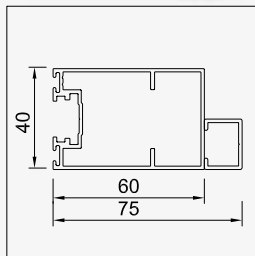

L50

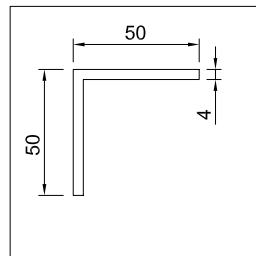

50.60L

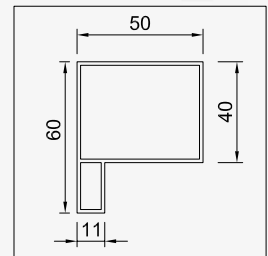

60SC.H

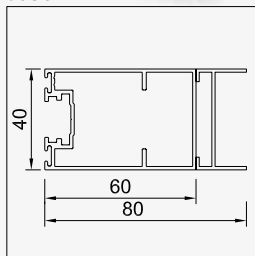

50.20L

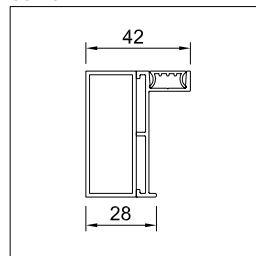

P60

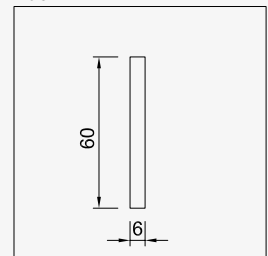

perfiles bastidor | profilés de cadre | frame profiles



40SC.P

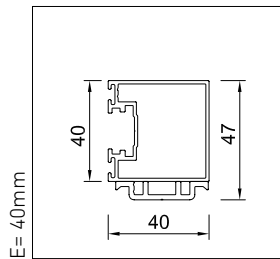

60SC.P

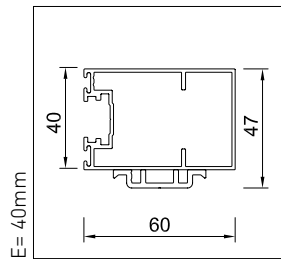

60AT

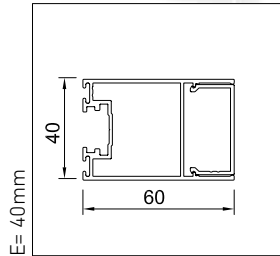

60AB

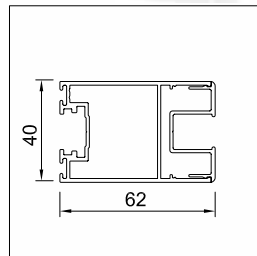

80.20H

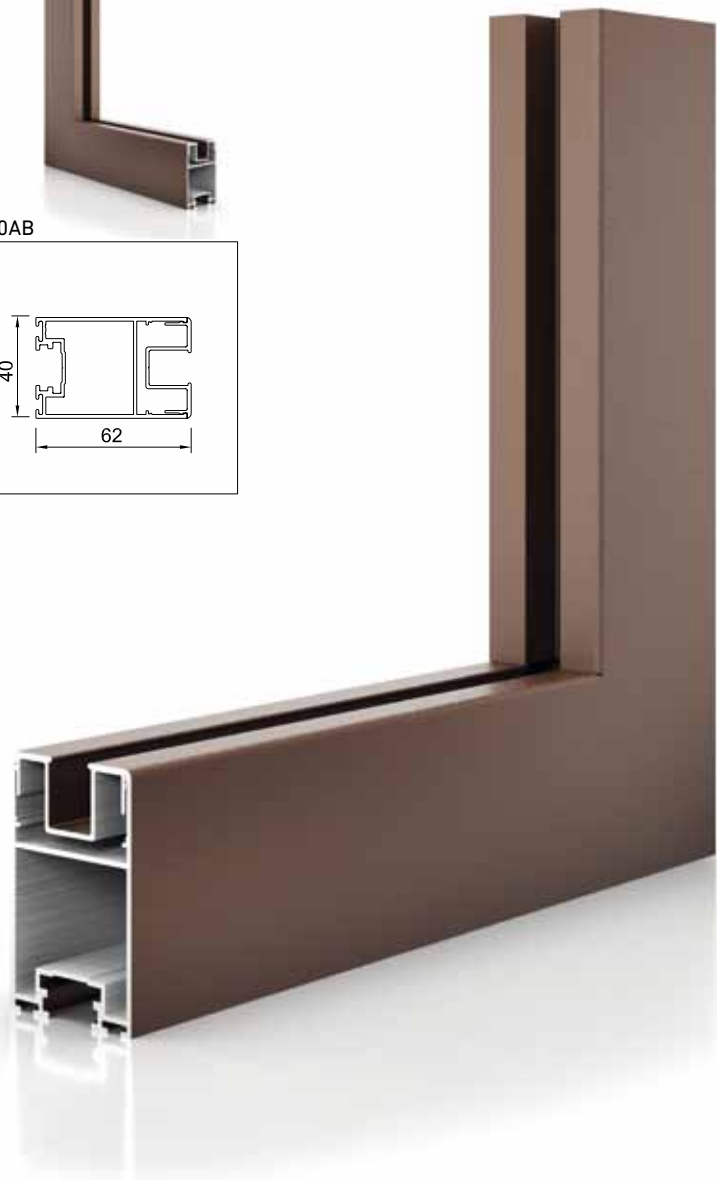
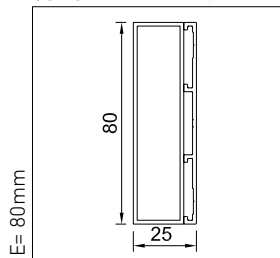

E= espesor bastidor | épaisseur de cadre | frame thickness



travesaños verticales | *montants centraux* | vertical transoms

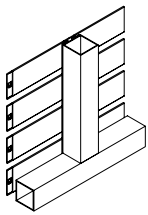

TV-40N.P

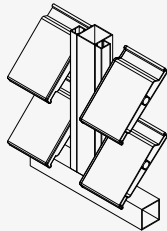
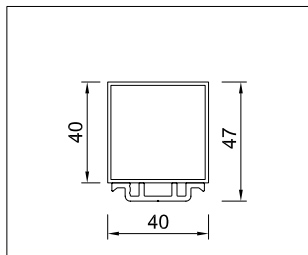

TV-40N.C

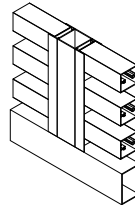
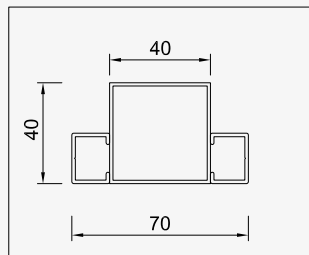

TV-40N.H

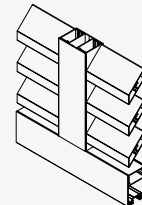
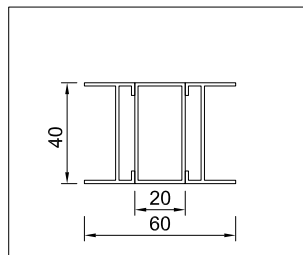

TV-60AT

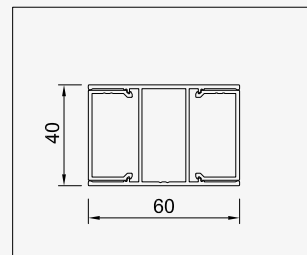

TV-60N.P

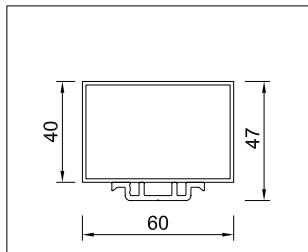

TV-60N.C

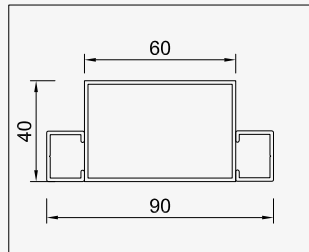

TV-60N.H

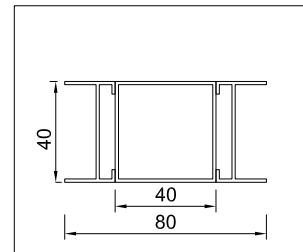

TV-60AB

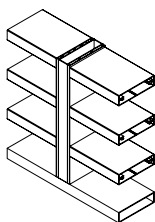
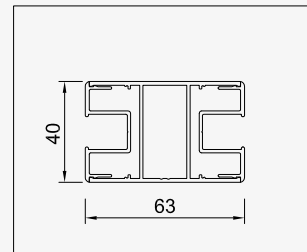

TV-80.20H

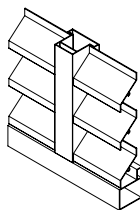
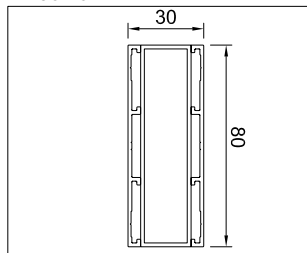

TV-60.50L

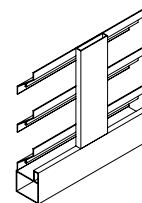
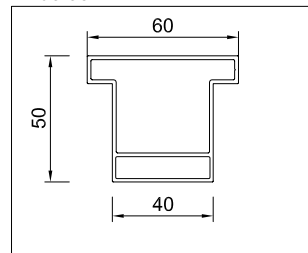

TV-60.11

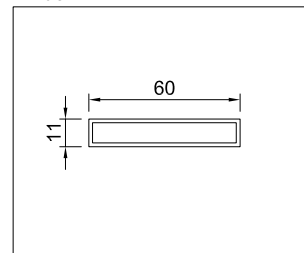

travesaños horizontales | *traverses centrales* | horizontal transoms

TH-40N

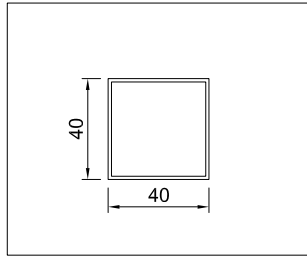

TH-60N

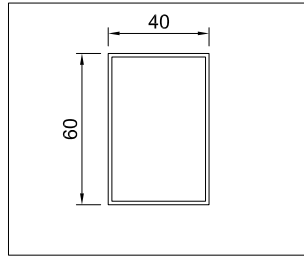

TH-40N.C

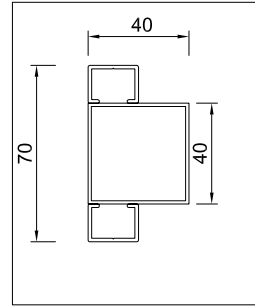

TH-60AT

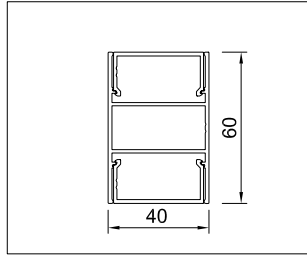

TH-60AB

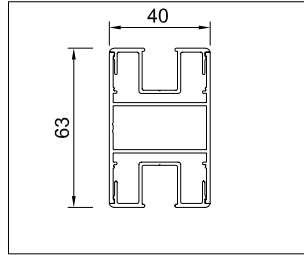

TH-60N.C

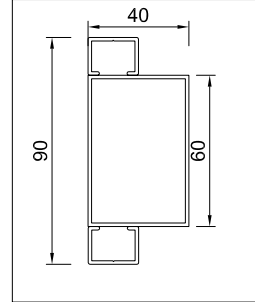

tapa lateral | *capot latéral* | side cover

SC-Tapa LP

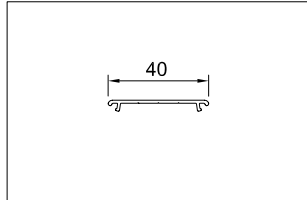

SC-Tapa LJ

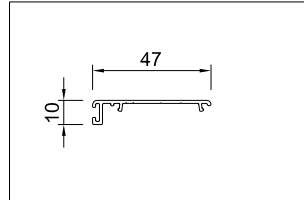

Bastidor | *cadre* | frame:

40SC ▶ 40SC.C ▶ 40SC.H

60SC ▶ 60SC.C ▶ 60SC.H

60AT ▶ 60AB

détail montage tapa lateral
détail du montage du capot latéral
 detail side cover assembly

